

PURAVANKARA

DESIGNED FOR
CHENNAI'S MODERN
ARISTOCRACY



PURVA
SOMERSET
HOUSE

The WorldHome Collection
Race Course Road, Guindy, Chennai



TRUTHS OF THE ARISTOCRACY



Think 'aristocracy' and you imagine bygone eras. But modern times have aristocrats too. They have reached the upper echelons of society with their dedication and vision. They balance tradition and newness. And Purva Somerset House is a grand ode to their spirit. Designed by the world's finest minds, immaculately detailed, and steeped in natural beauty, these homes promise to be the finest canvas for the modern aristocrat's life.

NOTE FROM THE CEO



Chennai is a city we hugely admire for its heroic history and rich cultural heritage. That's why it gives me great pleasure to present you with Purva Somerset House. Part of our WorldHome Collection, this is a home that has many things in common with Chennai's aristocracy. A graceful aura. Global influence. An innovative spirit. And much more. It's no wonder these homes are the ideal living spaces for the elite of Chennai. And like all fine things, it's exclusive. That's why we decided to have just one WorldHome in Chennai. So that Chennai's aristocracy need no longer dream of other lands but can now enjoy global experiences and an elevated lifestyle right at their doorstep.

Abhishek Kapoor

Chief Executive Officer, Puravankara Ltd.



Artistic impression

LUXURY HOMES DESIGNED BY THE BEST IN THE WORLD

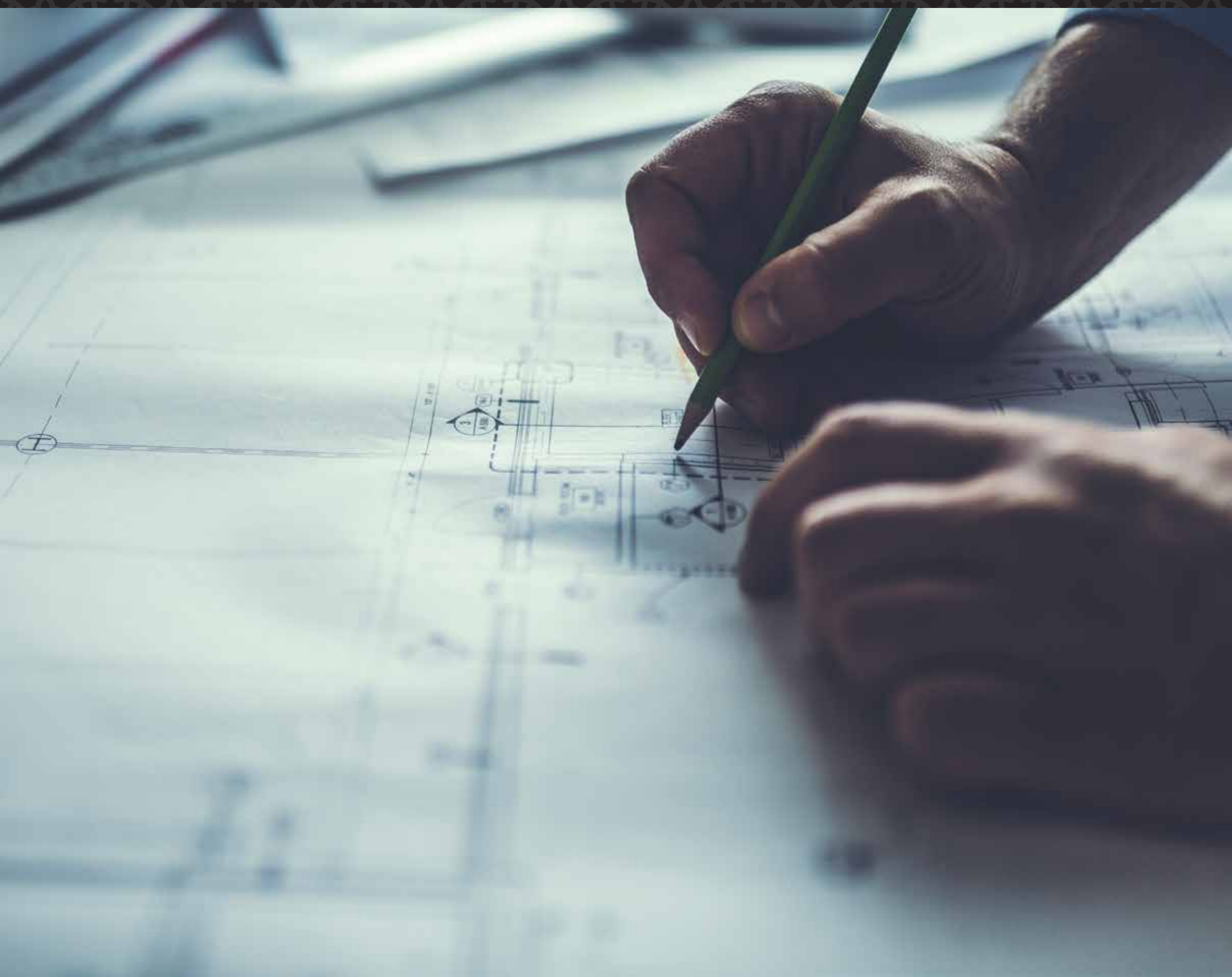

The aristocracy has always known the value of collaborations.

That's why for Purva Somerset House, we worked with some of the best minds in the world.



Hadi Teherani
Renowned German architect and designer

HADI TEHERANI | *FACADE DESIGN*

Hadi designed the facade of Purva Somerset House to create an international and timeless architectural statement. It borrows from traditional design elements of Tamil Nadu and global design trends creating a unique look. It is inspired by the geometry of intricate patterns of the traditional handmade Chettinad tiles which have been reimagined into modern jaali patterns and cladding design elements, thereby giving it a strong character rooted in rich heritage. In short, Purva Somerset House will be nothing short of magical.



Andy Fisher
Renowned Singapore-based architect

Andy Fisher workshop

ANDY FISHER | *CLUBHOUSE DESIGN*

Andy has over 30 years of experience working on international projects in Europe and Asia. Since founding the workshop in 2004, he has developed it into a creative and collaborative venue, undertaking a wide range of projects including hotels and resorts for international brands. He also has extensive experience in designing large-scale residential, commercial, and retail developments. Andy has envisioned and designed the Clubhouse at Somerset House, making it a space that brings elevating experiences and a global lifestyle to your doorstep.

THE WORLDHOME COLLECTION



Purva Somerset House is part of our prestigious WorldHome Collection. These homes have been designed for the quintessential 'world citizen' who shapes industries, influences organizations, and travels around the world. It's no wonder these homes deliver the highest level of luxury in every department - from immaculate details and renowned architects to elevated experiences and eco-friendly, tech-integrated living.

PURVA SOMERSET HOUSE

The WorldHome Collection
Race Course Road, Guindy, Chennai

PURVA ORIENT GRAND

THE WORLDHOME COLLECTION
Lalbagh Road, Bengaluru

PURVA ATMOSPHERE

THE WORLDHOME COLLECTION
Behind Manyata Business Park, Bengaluru

SIX TENETS THAT MAKE IT A WORLDHOME

FUTURE-THINKING LUXURY

Foreseeing the hidden layers of the good life with integrated planning

DIVERSE LUXURY

Weaving in latest best practices from experts around the world

SUPERLATIVE LUXURY

Crafting impeccable designs on par with the world's best luxury spaces

EXPERIENTIAL LUXURY

Curating elevating experiences for mind, body, and soul

GREEN LUXURY

Balancing man-made and nature-made via sustainability

INTELLIGENT LUXURY

Designing spaces that act like an extension of our minds

PURVA SOMERSET HOUSE IS OUR ONLY WORLDHOME IN CHENNAI

Boldly conceived, immaculately designed, it bears all the hallmarks of the aristocratic life



THE ARISTOCRACY DOESN'T GO TO THE WORLD.
IT COMES TO THEM



When Cleopatra sought Caesar's help to strengthen her empire, she went to Rome to meet him, bearing the best of the world
on a platter, from mesmerizing silks to rare delicacies.

PURVA SOMERSET HOUSE BRINGS THE BEST OF THE
WORLD TO YOU ON A PLATTER

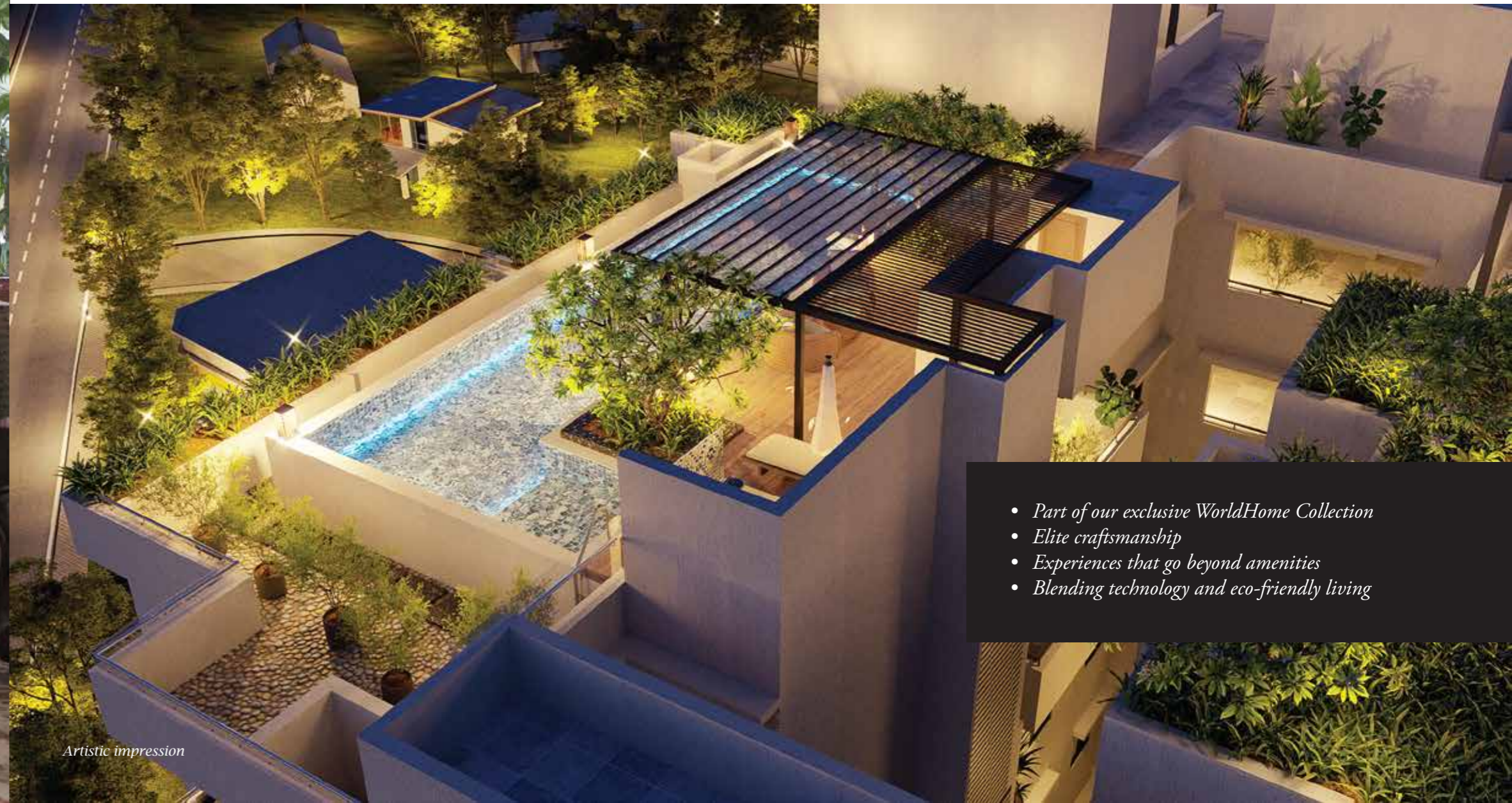

- Part of our exclusive WorldHome Collection
- Elite craftsmanship
- Experiences that go beyond amenities
- Blending technology and eco-friendly living

Artistic impression

NOTHING STANDS BETWEEN THE ARISTOCRACY AND A GOOD VIEW

For centuries, aristocrats always valued an expansive view. It offered sensory pleasures and an inspiring view of the horizon.

ENJOY UNOBSTRUCTED VIEWS OF NATURE'S RICHES AT GUINDY

- *A 270-degree view of acres of soothing greenery*
- *A panoramic view of the Madras Race Club*
- *Glimpses of the Guindy National Park*

THE ARISTOCRACY INDULGE THE CITY
OR ESCAPE IT, WHEN THEY PLEASE

Unhindered movement and access have always been important to the aristocracy,
whether to retreat from a battle or just escape the tedium of palace affairs.

LIVE IN GUINDY, ONE OF INDIA'S 10 PRIME INVESTMENT DESTINATIONS

- Get access to the city centre
- Travel quickly to the Metro Station and International Airport
- Be close to Phoenix Market City, educational institutes, hotels and hospitals

Chennai International Airport
8 kms

Kathipara Flyover

Guindy Metro
1 km

Five Furlong Road

Madras Race Club

Velachery Road

Towards Phoenix Marketcity
2 kms

Raj Bhavan
3 kms

Guindy National Park
3 kms

Velachery Road

Military Hospital

Central Institute of Plastic Engineering & Technology

To Koyembedu

UTI Infrastructure Technology & Services Ltd.,

SPIC Building

Guindy Flyover

ITC Grand Chola

To Central

Anna Salai - Mount Road

Park Hyatt

Centre for Distance Education

Tamil Nadu Science & Technology

Anna University Central Library

To Porur & Sriperumbudur

Sardar Patel Road

To Adyar

To Airport



MKN Road

Ashram School



Madras Race Club



Raj Bhavan



Five Furlong Road

Velachery Road

To Velachery & OMR

PURVA SOMERSET HOUSE

THE ARISTOCRACY ALWAYS ENJOYS RINGSIDE SEATS TO LIFE'S MAGIC

From King Leopold in old-world Vienna to Queen Elizabeth in modern London, the elite have always witnessed life's best from an exclusive vantage point.

GET A ROYAL VIEW OF THE RACECOURSE
FROM THE ASCOT SEATING LOUNGE

- The most privileged view of the Madras Race Club, India's oldest race track
- Private and connected to the action

NO MATTER WHERE YOU PLANT AN ARISTOCRAT, SHE ALWAYS BLOOMS



From the Gardens of Versailles in 15th century France to the Royal Botanic Garden in London,
gardens have always enthralled the aristocracy.

LUXURIATE IN ROOFTOP THEMED GARDENS



- *The Walled Garden, perfect for reading and contemplation*
- *The Sound Garden, a palette of musical textures*
- *The Fragrance Garden, a feast for your senses*



THE ARISTOCRACY IMAGINES A WORLD WITHOUT BOUNDARIES



The aristocracy has always had a special connection with water. The Greeks were famous for the 'Palaestrae' where swimming as exercise and social activity took off.

EMBRACE A SEAMLESS WORLD
IN THE INFINITY POOL

- Edges that appear to blend with the horizon
- A pristine space to unwind, with a sunset view

THE ARISTOCRACY NEEDS AMPLE ENERGY
TO LIVE ITS AMBITIONS



A city's aristocracy is always a sporty, active bunch. After all, living a grand vision requires a higher degree of stamina. From the polo field to the horse races to the tennis court, the aristocracy has its own special ways of keeping fit.



GET ACCESS TO NEXT-LEVEL FITNESS
AT OUR WORLD-CLASS GYMNASIUM

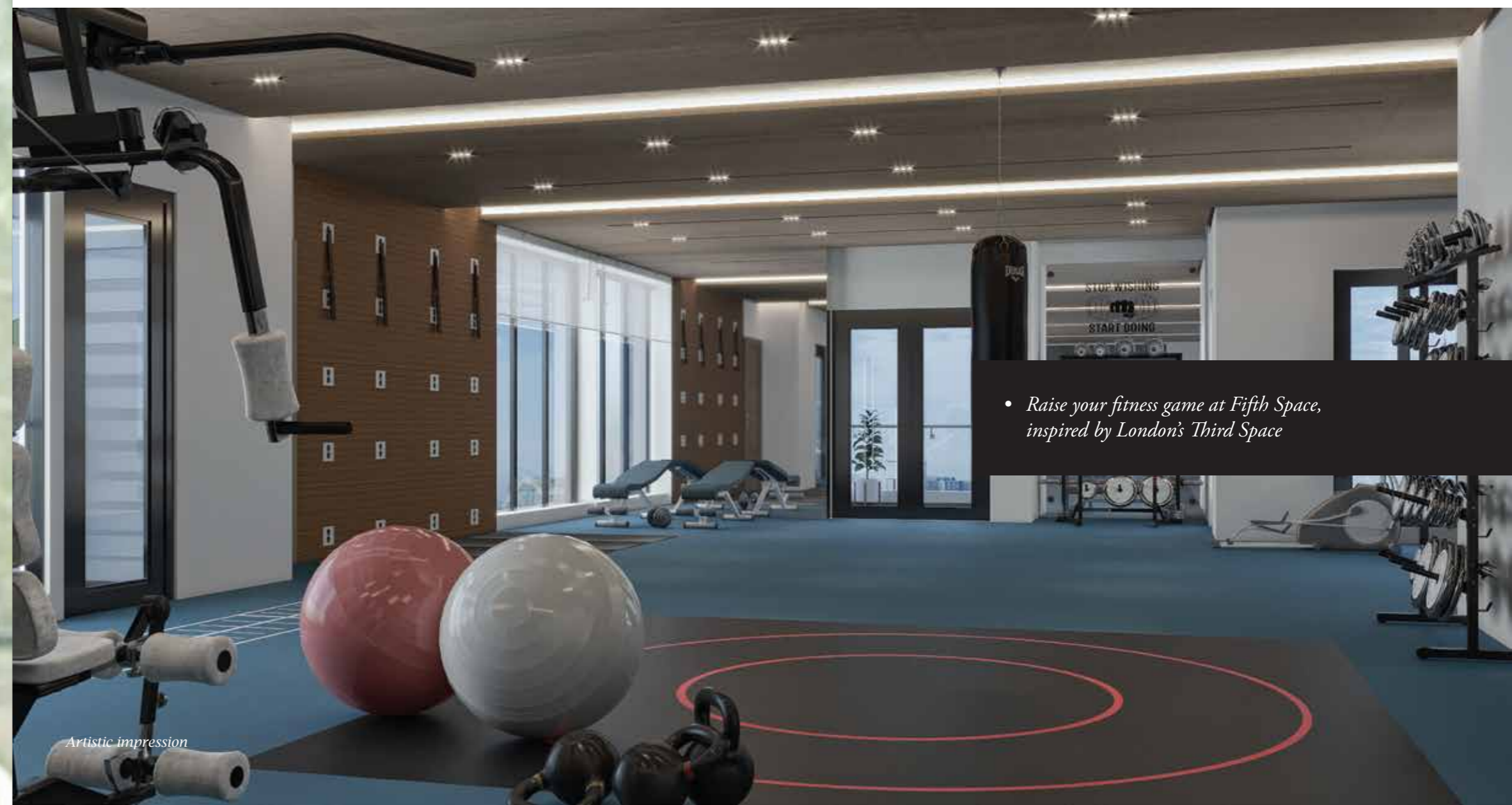

- *Raise your fitness game at Fifth Space, inspired by London's Third Space*

Artistic impression

THE ARISTOCRACY ALWAYS EMBRACES
A BREATH OF FRESH AIR



King Ashoka ensured the nurturing and safeguarding of trees in urban areas. In this way he championed the cause of sustainability and wellness centuries ago.



FRESH AIR AND FINE PLEASURES COMBINE
AT THE OXYGENATED CLUBHOUSE



- *Oxygenated air is regularly pumped into the clubhouse*
- *Savour a pollution-free, rejuvenating atmosphere*
- *Experience health benefits like reduced stress, increased energy levels, improved concentration and better sleep*

Artistic impression

A TRUE ARISTOCRAT HAS EYES AND EARS ALL
ACROSS THEIR KINGDOM



The aristocracy is always well informed. In the 16th century, the Queen's informants ensured
she knew everything important, sometimes even before it happened.

CONTROL YOUR KINGDOM FROM ANYWHERE
WITH BLUNEX INTELLIGENT HOMES



- *Feel super safe with biometric security*
- *Manage your home from the palm of your hand*
- *Drink water straight from the tap*

THE ARISTOCRAT'S LIVING ROOM IS A MIRROR OF HIS SPIRIT



The living room has always been the most sublime expression of the aristocrat's sensibilities. King George IV filled the Green Drawing Room at Windsor Castle with the finest furnishings and French artworks of the time.

EXPANSIVE LIVING ROOMS THAT INSPIRE YOUR FINEST LIFE



- *Generously designed, well-appointed apartment layouts*
- *Thoughtfully considers your life and its diverse needs*
- *Elegantly optimizes space*

Artistic impression

STARGAZING IS GRANDER
ON YOUR OWN PRIVATE TERRACE

Exploring constellations. Hosting a charming, sumptuous soiree. Or just lounging about at home on a Sunday. These are a few of the extraordinary experiences the aristocracy can indulge in when they have their own private terrace.

ULTRA-LUXURIOUS PENTHOUSES FOR CHENNAI'S ARISTOCRACY

- *Spacious top floor residences*
- *Featuring an 800 sq. ft private terrace*

PURAVANKARA: CREATING BETTER WORLDS



Backed by a 47-year-old legacy, Puravankara is one of the top 4 listed developers in India. We pioneered on many fronts: we were the first to bring FDI in Indian real estate, design theme-based projects, and unlock affordable housing. Our strong values, deep customer centricity, robust engineering, and complete transparency have earned us accolades as well as the respect of customers across the world.

| | | |
|------------------------------------|---------------------------|---------------------------------|
| 1.7 LAKH HAPPY RESIDENTS | 9 INDIAN CITIES | 42,500+ HOMES DELIVERED |
| 43 MILLION SQ. FT. DEVELOPED | 70+ ICONIC PROJECTS | 150+ AWARDS OF EXCELLENCE |

PURAVANKARA
RESIDENTIAL
Luxury apartments & villas

PROVIDENT
RESIDENTIAL
Premium development

PURAVANKARA
COMMERCIAL
Tech / Business parks

PURVALAND
PLOTTED DEVELOPMENT
Theme based unique plotted developments

STARWORTH
INFRASTRUCTURE & CONSTRUCTION LTD.
Engineering & Constructions

PURVA® STREAKS
Interior design

propmart
Real estate services

THE ARISTOCRATIC LIFE AWAITS YOU AT PURVA SOMERSET HOUSE





FOR MORE ENQUIRIES

CALL NOW

KARAN ASHOK : 98840 35958